

HD PATIO BOLT LOCK INSTALLATION INSTRUCTIONS

SUITABLE FOR

- SLIDING DOORS
- INWARD OPENING DOORS
- OUTWARD OPENING DOORS
- FRENCH DOORS

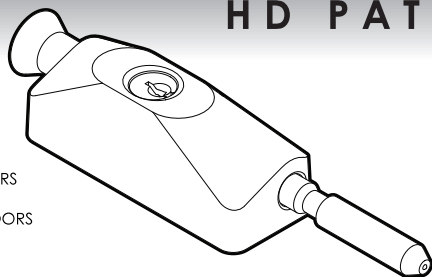

PACKAGED COMPONENTS

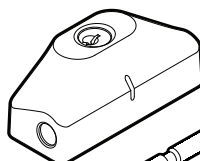

LOCK BODY

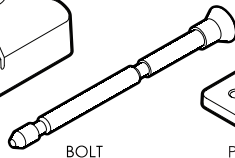

BOLT



PACKER

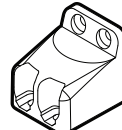

RECEIVER

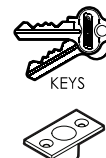

KEYS



STRIKE

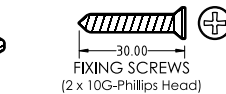

FIXING SCREWS
(2 x 10G-Phillips Head)



STRIKE SCREWS
(2 x 8G-Phillips Head)



FERRULE SCREWS
(2 x 4G-PHILLIPS HEAD)



FIXING SCREWS
(2 x M3 Self Tapping)



FIXING SCREWS
(2 x M5 Self Tapping)

TOOLS REQUIRED

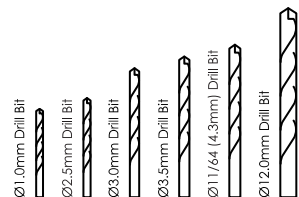

Phillips Head Screw Driver



Pointed Instrument / Scribe

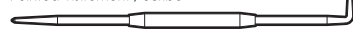

Pencil

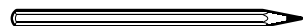

CYLINDER REMOVAL

CYLINDER REMOVAL

Using a phillips head screw driver, remove the 2 x M4 screws & then remove the cylinder holder. Once the cylinder holder has been removed, the cylinder can then be removed.

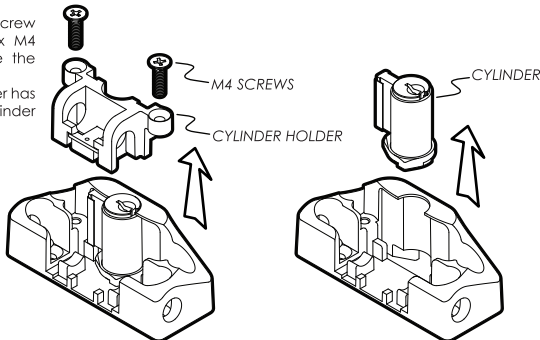

CAM ORIENTATION

CAM INSTALLATION & ORIENTATION

The cam & end plate is secured to the cylinder via 2 x 3/32 BSW screws.

NOTE:

The orientation of the cam is dependant on the orientation of the cylinder inside the lock body.

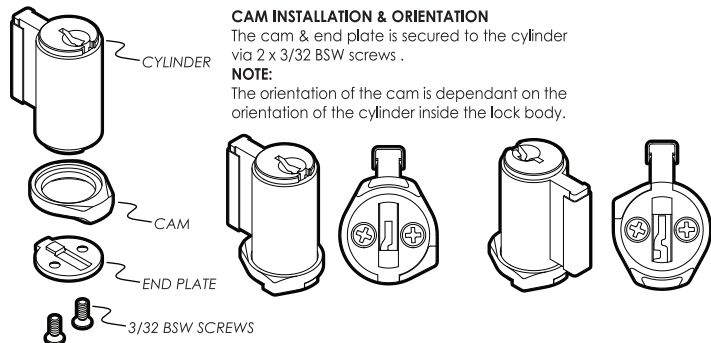

FIXING INSTRUCTIONS

1. REMOVING THE BOLT

Unlock the patio bolt & utilizing a pointed instrument or scribe, press down the bolt retaining mech & pull out the bolt.

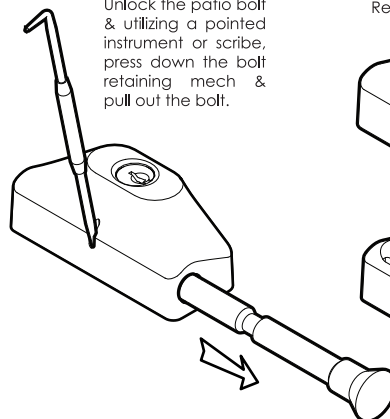

2. REMOVING THE TOP COVER

Remove the top cover.

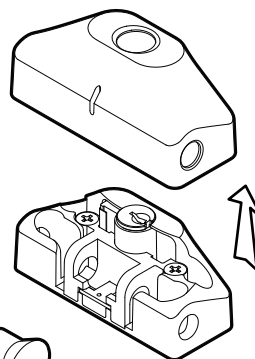

3. FIXING LOCATION

Using a pencil, mark the screw hole location & drill 2 x pilot holes, using a Ø3.5mm drill bit for wood & a Ø11/64 (Ø4.3mm) drill bit for aluminium.

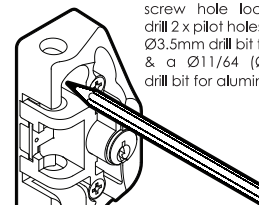

NOTE:
Check clearances for the screws & lock body

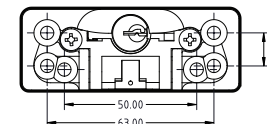

4. ATTACHING THE LOCK BODY

Select the 2 x fixing screws required & screw the lock body into its location, using the packer if necessary. Refit the top cover.

NOTE:

Use the 2 x 10G screws for wood & the 2 x Self Tapping screws for aluminium.

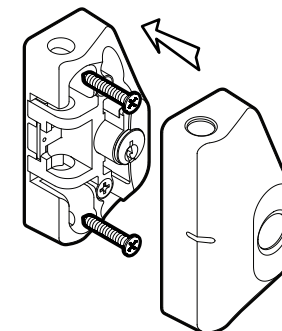

5. INSERTING THE BOLT

Insert the bolt in the direction required. Once the bolt is in place, firmly press the bolt to mark the drilling location of the bolt hole. Drill a hole using a Ø12mm drill bit. Check the bolt operation & that the lock body remains clear of any obstacles.

NOTE:

The bolt can be inserted in either direction without rotating the lock body.

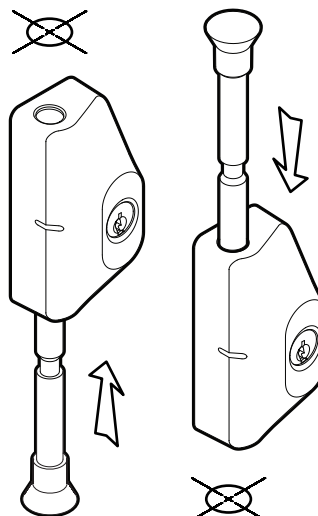

6. FERRULE, STRIKE & RECEIVER INSTALLATION

Place the ferrule, bolt hole sleeve, strike or receiver into position & mark the 2 x screw locations. Drill 2 x pilot holes using a Ø1.0mm drill bit for the ferrule, Ø2.50mm drill bit for the bolt hole sleeve & a Ø3.00mm drill bit for the receiver & strike. Screw on the ferrule using the 2 x 4G screws, or screw on the bolt hole sleeve using the 2 x M3 self tapping screws, or use the 2 x 8G screws for the receiver & strike.

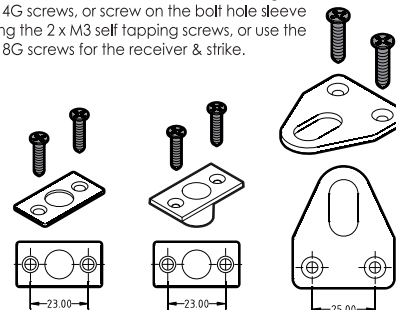

FERRULE

BOLT HOLE SLEEVE

STRIKE

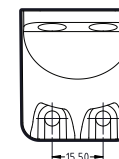

RECEIVER

